

### Unpacking

Before you begin using the device, please check the version you got and ensure that the following items are included in the shipped box:

#### Mainframe Accessories :

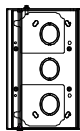

Rotary bracket x 1

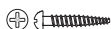

ST4x20 screw x 4



Plastic wall anchor x 4



M4x10 screw x 4



M3x8 Torx screw x 2



Torx wrench x1



Allen wrench x 1

### Installation

#### Step1: Rotary Bracket Installation

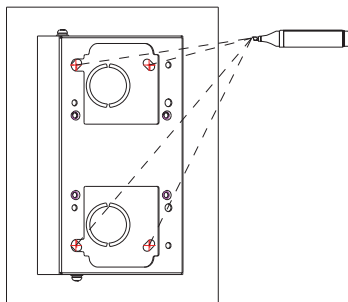

Mark the four holes of the rotary bracket on the wall.

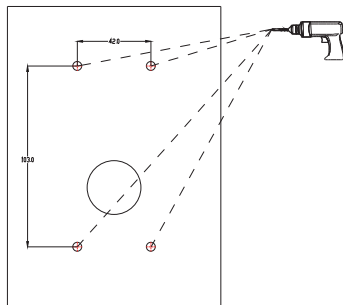

Use a hand drill with 5mm diameter bit to make the holes (20 mm in depth) in the marked positions.

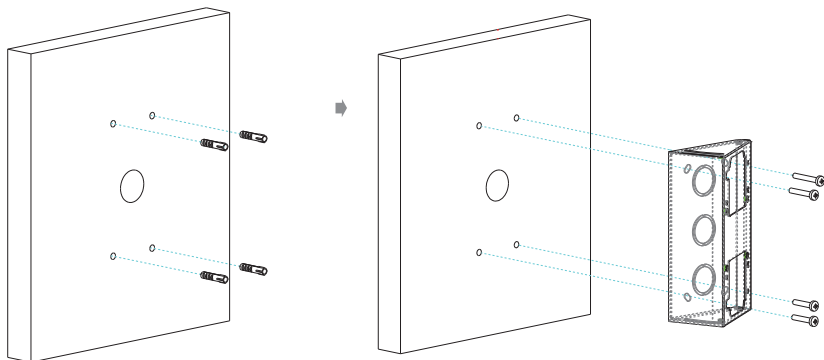

Insert the four plastic wall anchors into the four drilled holes.

Fix the rotary bracket onto the four plastics wall anchors using four ST4 x20 screws, and make sure the bracket is square to the wall.

### Step2: Wall-mounting Bracket Installation

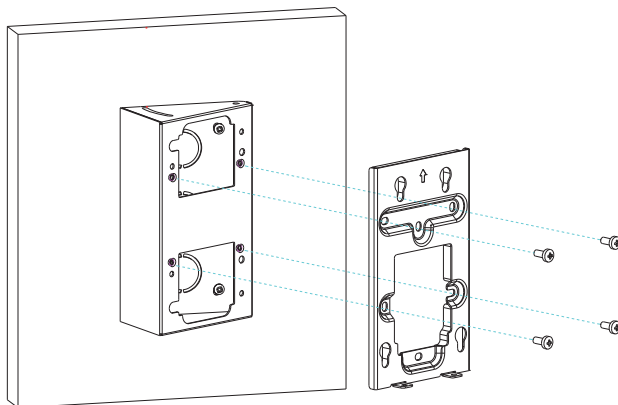

Fix the the wall-mounting bracket onto the rotary bracket using four M4x10 screws.

### Step3: Rotary Bracket Adjustment

Note: Please refer to R20A or R20A-2 quick guide to install the device back cover and to hang the device on the wall-mounting bracket.

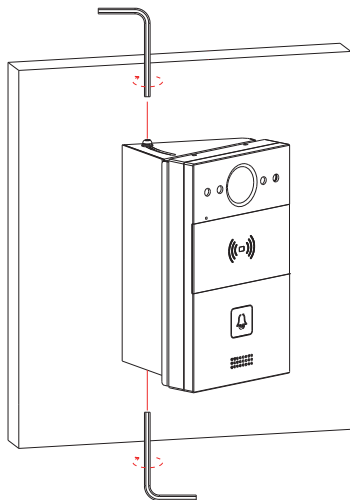

Fix the M3x8 Torx screws onto the rotary bracket using the Torx wrench, then tighten the screws at the appropriate rotary angle.

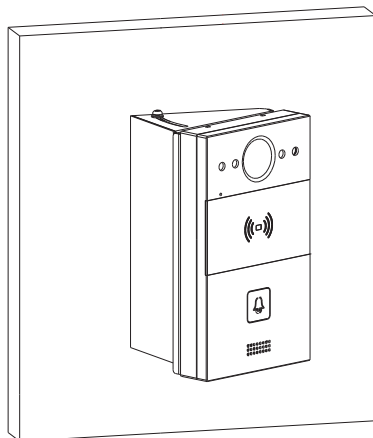

Installation completed.

### Notice Information

Information contained in this document is believed to be accurate and reliable at the time of printing. This document is subject to change without notice, any update to this document can be viewed on Akuvox' s website: <http://www.akuvox.com> © Copyright 2021 Akuvox Ltd. All rights reserved.



**AKUVOX (XIAMEN) NETWORKS CO., LTD.**

ADD: 10/F, NO.56 GUANRI ROAD, SOFTWARE PARK II, XIAMEN 361009, CHINA  
[www.akuvox.com](http://www.akuvox.com)